

Stylish planning with confidence: use the AXOR ComfortZone test to find the right wash basin for your Axor Starck mixer – and vice versa.



The ideal mixer/wash basin combination: perfectly matched aesthetically, and technologically tested. This prevents any annoying splashing and staining around the wash basin area.



AXOR tested all the AXOR Starck basin mixers with the leading manufacturers' most popular washbasins in the ComfortZone test, its specially developed realistic test procedure. The space under the mixer and the splash behaviour are tested in this performance test of mixer and basin. Detailed information on the ComfortZone test can be found at: pro.hansgrohe-int.com/axor-washbasin-matrix

CERAMIC TYPES

Always find the matching Axor Starck mixer to go with the familiar basin types. The AXOR ComfortZone test is a comprehensive guidance document for the perfect installation of the mixer and washbasin for pleasant, splash-free washing. Five different ceramic types were tested in the AXOR ComfortZone test:

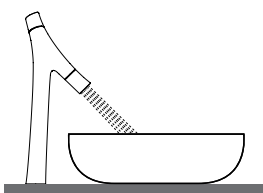

Washbasin with the mixer behind it

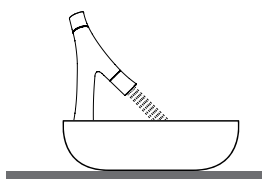

mixer behind it
Washbasin with the mixer on top of it

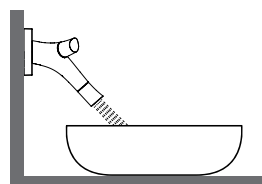

Washbasin with the mixer on the wall

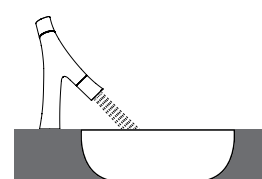

Undermount or top-mounted basin with free standing mixer

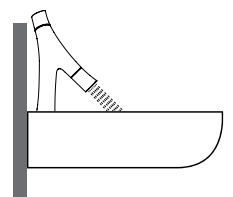

Wall-mounted washbasin with the mixer on it

You can use the results of the ComfortZone test free now at: pro.hansgrohe-int.com/axor-washbasin-matrix

Manufacturer and washbasin line

The screenshot shows a technical document titled 'AXOR_CriterioE_ComfortZone_Test_EN.pdf'. It features a table of recommended combinations for AXOR Starck mixers and KALDEWEI washbasins. The table is organized by mixer model (Puro and Puro 800) and washbasin size (400mm, 500mm, 600mm). The columns represent different mixer models. The table cells contain symbols indicating the recommended combination, whether the tap hole is pushed through, prepared, or not present.

Below the table, there are diagrams showing mounting dimensions for different installation situations. The dimensions are labeled as follows:

- For 400mm washbasin: a1 = 40mm, a2 = 45mm, a3 = 50mm, a4 = 100mm
- For 500mm washbasin: b1 = 50mm, b2 = 55mm, b3 = 60mm, b4 = 90mm, b5 = 100mm
- For 600mm washbasin: c1 = 185mm, c2 = 220mm
- For 400mm washbasin with different tap hole: d1 = 0mm, d2 = 45mm, d3 = 55mm, d4 = 65mm, d5 = 85mm, d6 = 100mm, d7 = 120mm
- For 500mm washbasin with different tap hole: e1 = 35mm, e2 = 50mm, e3 = 100mm, e4 = 120mm

A legend below the dimensions explains the symbols used in the table:

- ✓ = Recommended combination
- = Tap hole pushed through
- = Prepared tap hole
- ⊗ = Without tap hole

On the left side of the document, there is a sidebar with a list of sections: 'AXOR Comfortzone Test', 'Instructions', and 'Kaldewei'. The 'Kaldewei' section is currently selected.

AXOR Starck

mixer and item number

Recommended combinations

WASHBASIN WITH ITEM NUMBER AND DETAILS OF SIZE (different item numbers refer to different version of tap hole and overflow versions)

Mounting dimensions for different installation situations

Information WASHBASIN TYPE

The TABLE OF CONTENTS makes it easy to get to your chosen ceramic line.

WHICH AXOR STARCK MIXER SUITS WHICH BASIN ?



KALDEWEI

AXOR Starck											
		#10116000	#10111000	#10120000	#10123000	#10001000	#10007000	#10102000	#10103000		
 Puro	460x460	#901306013 ●	✓	✓			✓	✓	✓		
		#901306003 ⊗									
		#901306033 ●									
	600x460	#901406013 ●	✓	✓			✓	✓	✓		
		#901406003 ⊗									
		#901406033 ●									

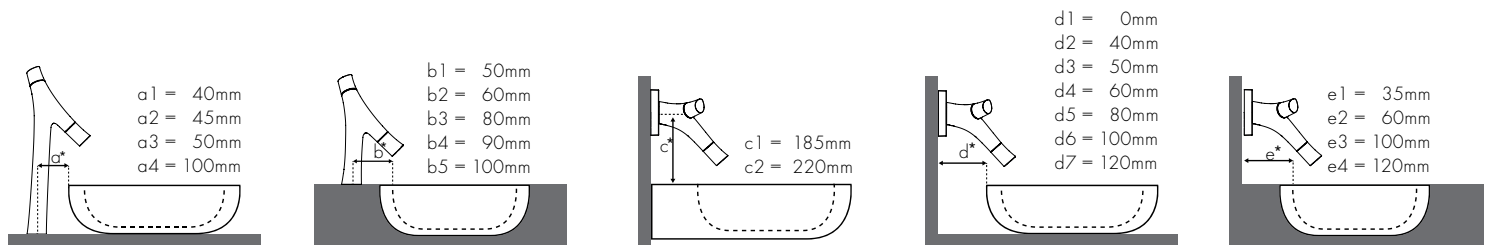

✓ = Recommended combination / ● = Taphole pushed through / ○ = Prepared taphole / ⊗ = Without taphole



WHICH AXOR STARCK MIXER SUITS WHICH BASIN ?

AXOR

KALDEWEI

AXOR Starck										
		#10116000	#10111000	#10120000	#10123000	#10001000	#10007000	#10102000	#10103000	
 900x 460	#901506013 ●	✓	✓			✓	✓	✓		
	#901506003 ⊗									
	#901506033 ●									
	 1300x 460	#906706043 ●	✓	✓			✓	✓	✓	
		#906706003 ⊗								
		#906706053 ●								
 550x 300	#049160..00 ●	✓	✓			✓	✓	✓		
	#049160..27 ●	✓	✓			✓	✓	✓		
	#901506003 ⊗	✓	✓			✓	✓	✓		
 550x 300	#901506033 ●	✓	✓			✓	✓	✓		
	#901506003 ⊗	✓	✓			✓	✓	✓		

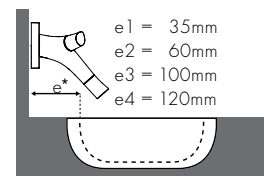
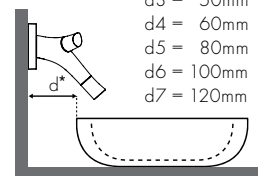
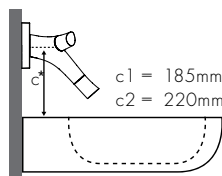
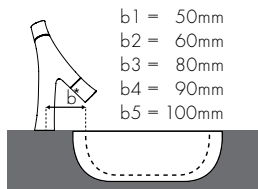
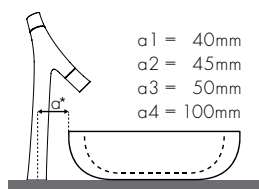

✓ = Recommended combination / ● = Taphole pushed through / ○ = Prepared taphole / ⊗ = Without taphole



WHICH AXOR STARCK MIXER SUITS WHICH BASIN ?



KALDEWEI

AXOR Starck											
		#10116000	#10111000	#10120000	#10123000	#10001000	#10007000	#10102000	#10103000		
	460x460	#900606013 ●	✓	✓			✓	✓	✓		
		#900606003 ⊗									
		#901506033 ●									
	600x460	#900706013 ●	✓	✓			✓	✓	✓		
		#90070600 ⊗									
		#900706030 ●									
	900x460	#900806013 ●	✓	✓			✓	✓	✓		
		#900806003 ⊗									
		#900806033 ●									

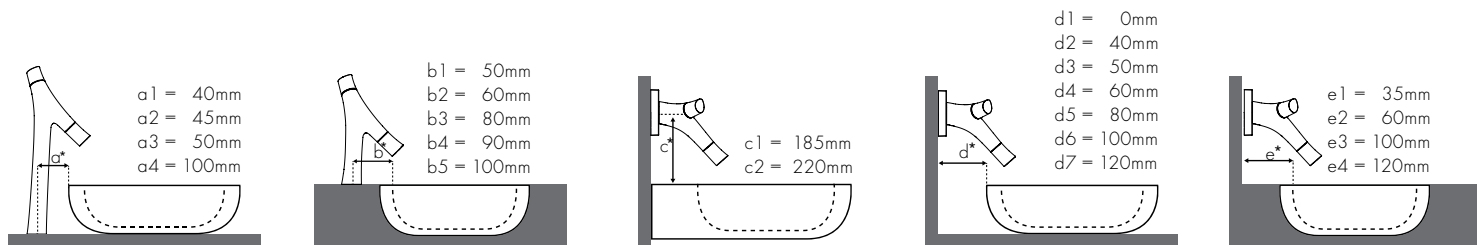

✓ = Recommended combination / ● = Taphole pushed through / ○ = Prepared taphole / ⊗ = Without taphole



WHICH AXOR STARCK MIXER SUITS WHICH BASIN ?



KALDEWEI

AXOR Starck									
		#10116000	#10111000	#10120000	#10123000	#10001000	#10007000	#10102000	#10103000
 1300x 460	#907206043 ●	✓	✓			✓	✓	✓	
	#907206003 ⊗								
	#907206053 ●								
 460x 460	#900306013 ●	✓	✓			✓	✓	✓	
	#900306003 ⊗								
	#900306033 ●								
 600x 460	#900406013 ●	✓	✓			✓	✓	✓	
	#900406003 ⊗								
	#900406033 ●								

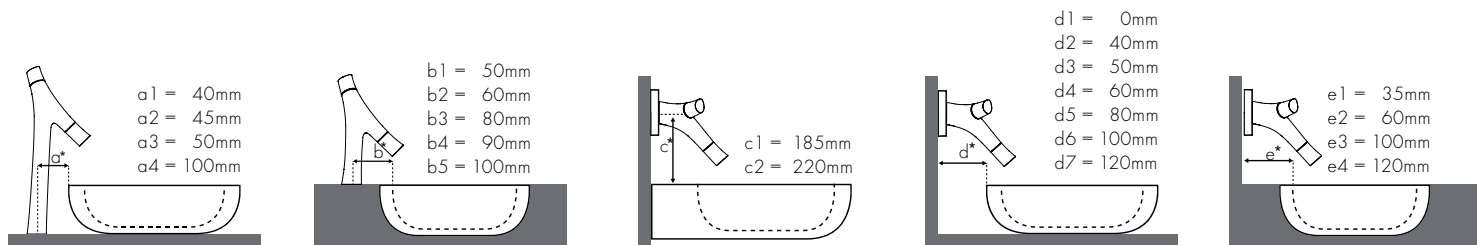

✓ = Recommended combination / ● = Taphole pushed through / ○ = Prepared taphole / ⊗ = Without taphole



WHICH AXOR STARCK MIXER SUITS WHICH BASIN ?



KALDEWEI

AXOR Starck									
		#10116000	#10111000	#10120000	#10123000	#10001000	#10007000	#10102000	#10103000
 900x 460	#900506013 ●	✓	✓			✓	✓	✓	
	#900506003 ⊗								
	#900506033 ●								
 460x 460	#900006013 ●	✓	✓			✓	✓	✓	
	#900006003 ⊗								
	#900006033 ●								
 600x 460	#900106013 ●	✓	✓			✓	✓	✓	
	#900106003 ⊗								
	#900106033 ●								

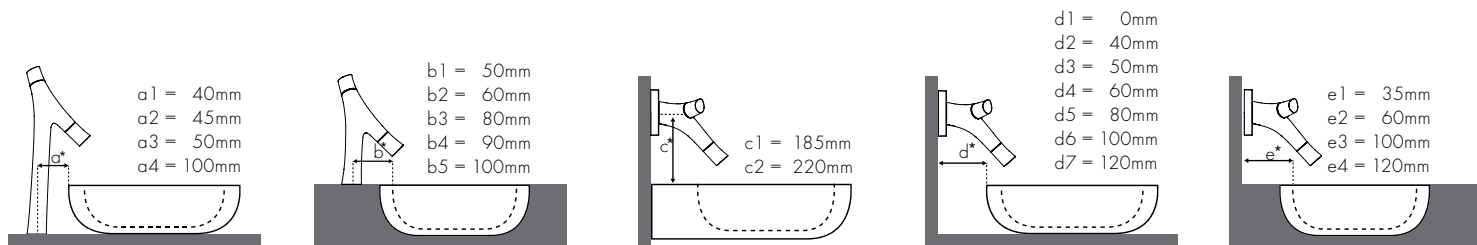

✓ = Recommended combination / ● = Taphole pushed through / ○ = Prepared taphole / ⊗ = Without taphole



WHICH AXOR STARCK MIXER SUITS WHICH BASIN ?



KALDEWEI

AXOR Starck									
		#10116000	#10111000	#10120000	#10123000	#10001000	#10007000	#10102000	#10103000
 900x 460	#900206013 ●	✓	✓			✓	✓	✓	
	#900206003 ⊗								
	#900206033 ●								
 460x 460	#900906003 ●	✓	✓	✓	✓	✓	✓	✓	
	#901006003 ⊗	✓	✓	✓	✓	✓	✓	✓	
	#901106003 ●	✓	✓	✓	✓	✓	✓	✓	

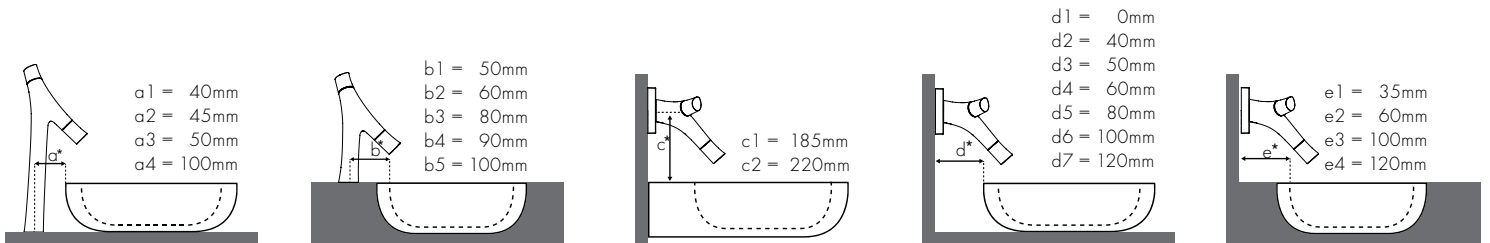

✓ = Recommended combination / ● = Taphole pushed through / ○ = Prepared taphole / ⊗ = Without taphole

